



MPR M1007 Remote transmission usage and maintenance manual V 1. 0



catalogue

1 Product overview.....	1
2 Product features.....	1
3 Main technical indicators.....	1
4 Function Description.....	1
5 Installation and external wiring of remote transmission instrument.....	3
6 Precautions.....	5
7 Common troubleshooting methods.....	5
8 Warranty period.....	5

1. Product overview

The MPR M1007 can transmit data via CAN communication or 485 communication to read parameters such as engine speed, oil pressure, water temperature, oil temperature, battery voltage, and cumulative engine operating time from the side control box, and can display these parameters in real-time. When the side control box detects an alarm signal, the MPR M1007 instrument synchronously displays the alarm. Through this MPR M1007 instrument, starting and stopping operations of the engine can be achieved in remote control mode. The optional Yunmao features include GPS positioning, cloud monitoring, cloud services, and a global maintenance platform.

2. Product features

MPR M1007 Far transmission, among similar products, it has the characteristics of good reliability, good stability, small size, easy installation and maintenance, and is a relatively advanced mechatronic electronic instrument. It can be equipped with cloud cat function, GPS positioning, cloud monitoring, cloud service, and global maintenance platform.

3. Main technical indicators

3.1 (a) Requirements for product usage environment

Working environment temperature: $-20^{\circ}\text{C}\sim+60^{\circ}\text{C}$, storage temperature: $-30^{\circ}\text{C}\sim+70^{\circ}\text{C}$.

(b) The control box can work reliably for a long time in the environment with salt spray, oil mist, mold and dust.

(c) Protection class: IP55

3.2 Power supply

The working voltage of far transmission instrument is DC24V/DC12V universal, and it can work normally when the voltage deviates from the rated value-25% to +30%.

3.3 Meet the relevant electromagnetic compatibility requirements

4. MPRM1007 remote transmission function description

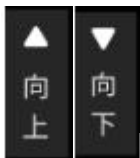

- 1) **Page-turning button:** switch the displayed content (engine parameters, etc.) when in the main interface, select the parameter number when in the parameter selection interface, and set the number when in the edit parameter interface.



- 2) **Page flip button:** switch the displayed page when in the main interface, select the parameter bit when in the parameter selection interface, and set the number when in the parameter editing interface.



- 3) **Return button:** Press this button to return to the main page from other pages, and press this button when you are on the main page to return to the simple display interface.



- 4) **Confirm button:** used to enter the corresponding sub-menu on the parameter selection setting page, and press this button to complete the write-in function of parameter modification when the parameter is modified.



- 5) **Silencing button:** When there is an alarm signal, press the <silencing> button to eliminate the output of sound signal, and the corresponding alarm light will change from flashing to flat light.



- 6) **Reset button:** When the instrument has an alarm item, press this button to restore the alarm-free state.



- 7) **Idle/rated button:** In remote control mode, the remote instrument can be used to control the idle/rated function of the engine.



- 8) **Start button:** In remote control mode, pressing this button can realize the remote transmission of instrument to control engine start.



- 9) **Stop button:** In remote control mode, pressing this button can realize the remote instrument control to stop the engine.



- 10) **Emergency stop button:** In any mode, pressing this button can realize the remote instrument control of the engine emergency stop.



- 11) **Light control knob:** rotate this knob to control the dimming and brightening of the remote instrument screen.

5. Installation and external wiring of remote transmission instrument

5.1 External

size:242×173×97.5mm.

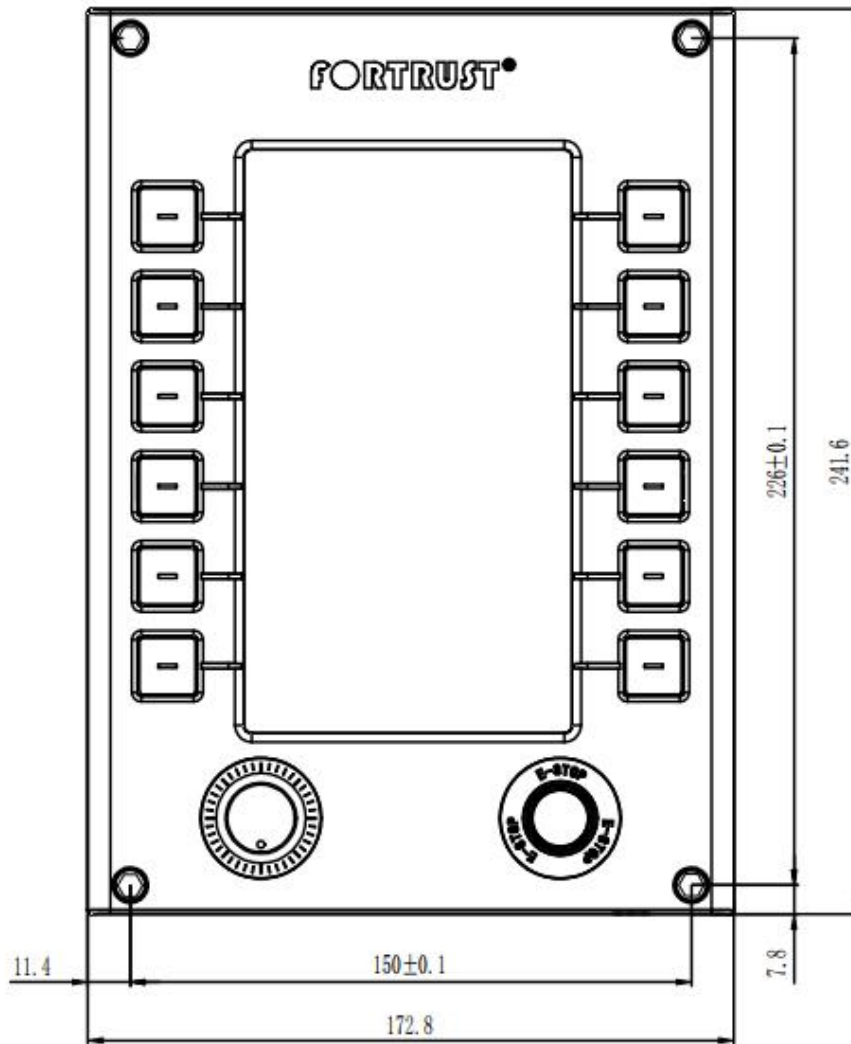

5.2 Embedded Installation: It is recommended that the box opening size be 225 x 162mm.

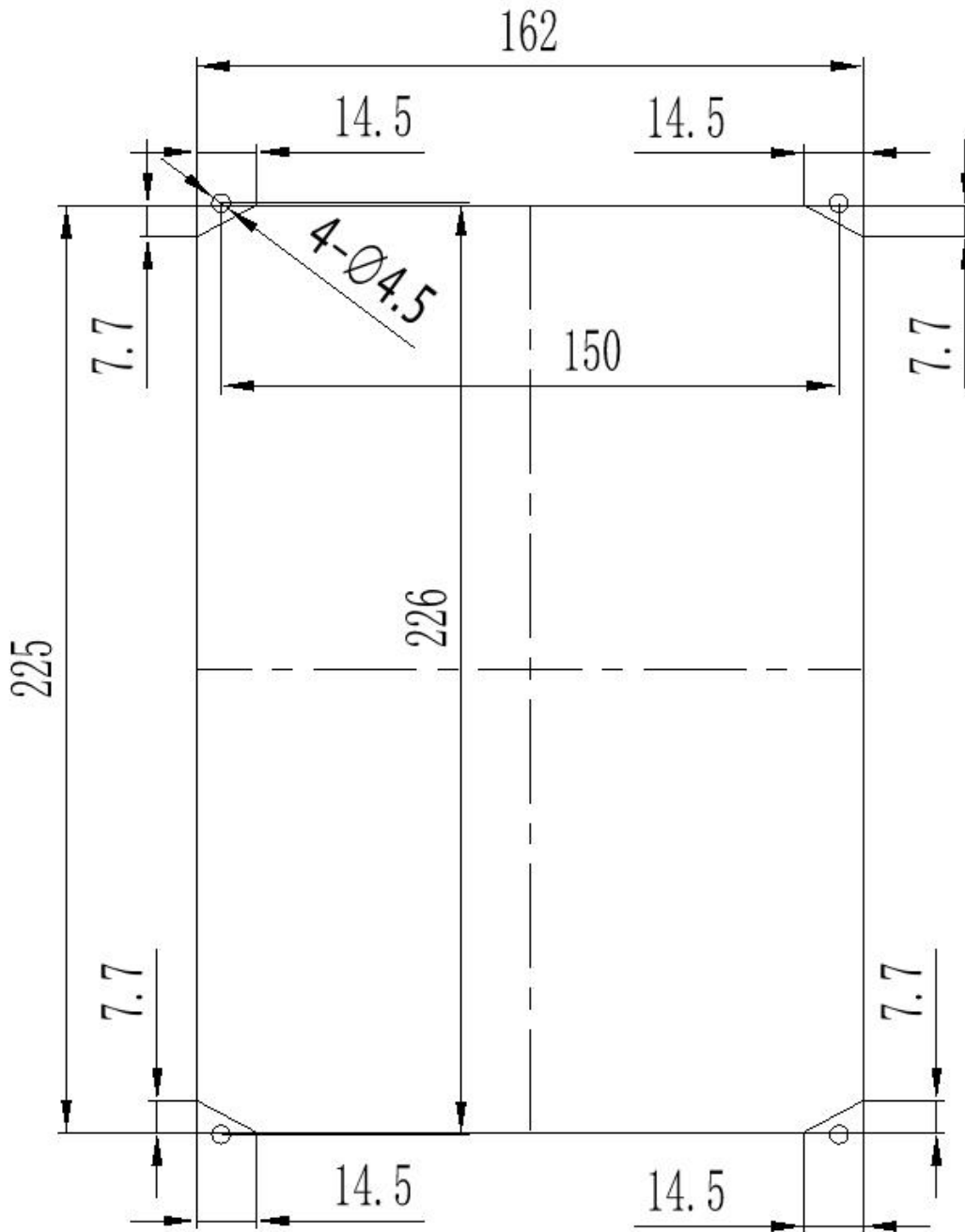

5.3 Bracket installation: It is recommended that the base hole size be 115 x 70mm.

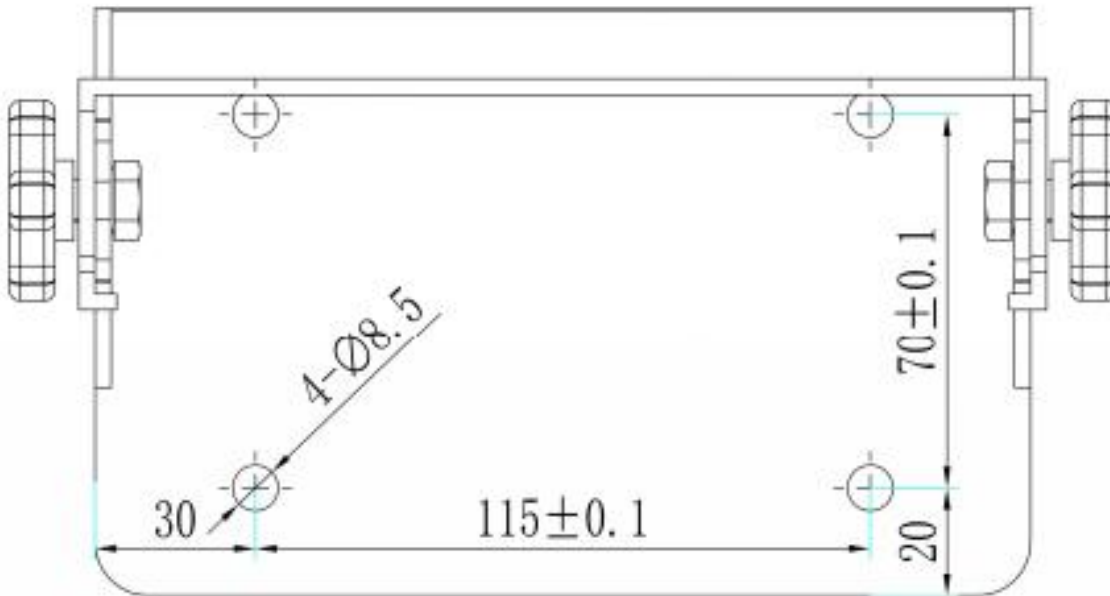

5.4 Wiring definition

External wiring connection: quick plug-in type

接口定义1

Interface Definition 1

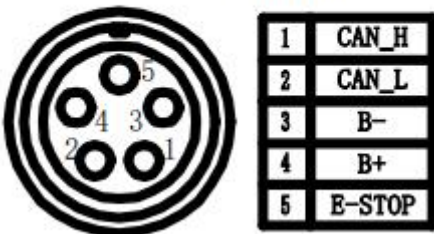

6. Precautions

1) This remote transmission instrument only reads the parameters of the control box beside the machine, monitors the engine parameters, and starts and stops in remote control mode.

2) Do not press the <Reset>, <Start>, <Stop> buttons at will when the engine is running normally.

3) Check the remote instrument joints frequently to see if they are eroded by oil and water or loose.

4) The signal cable should be laid separately from the power cable to avoid electromagnetic interference, and should not touch the exhaust pipe and other high temperature parts.

7. Common troubleshooting methods

Common faults	failure cause	Exclusion method
The meter does not light up when the machine is turned on	1. Power circuit break or polarity reverse	1. Check the line and connect it correctly
The data has been in the initial position, Report communication failure	1. Communication line break or reverse connection	1. Check the line and connect it correctly
Pressing the emergency stop has no response	1. Loose connection 2. Wrong wiring	1. Check the connection and reconnect the connection

After the above treatment, if the fault still cannot be eliminated, please find a professional for maintenance.

8. Warranty period

The warranty period of Yuan Chuan instrument under normal storage, use and maintenance conditions is one year after loading or 18 months from the date of factory delivery.



Address: Room 803, Building A, Senlan Meilun Building, No.555 Lansong Road, Pudong New Area, Shanghai

Telephone: 198513513 21

Postal code: 200137

Factory address: No.49 Mingzhu Road, Binhai Industrial Park, Qidong City, Jiangsu Province

Telephone: 19851351386

Postal code: 226236

WeChat official account: Fu Chuang Power

URL:www.fortrustpower.com

postbox:info@fortrust.cn

